



HERITAGE CENTER TECHNICAL RIDER

Technical Director

Bruce Barr bruce@cam-plex.com

Assistant Technical Directors

Kit Reyne kit@cam-plex.com
Adam Skoglund adam@cam-plex.com



Theater Manager

Jaymi Gilmour-Crowley
jaymi@cam-plex.com

Ticket Office

307-682-8802

1635 Reata Drive
Gillette, WY 82718
Office: 307-682-0552 Fax: 307-682-8418

www.cam-plex.com

(Revised 8/18/2011)

MicrosoftWord S: Technical/Forms/HeritageCenterTechnicalRider

GENERAL INFORMATION	3
Handicapped Access	3
Production Room	3
Green Room	3
Rehearsal Room	3
Stage Manager’s Console	3
Crews	3
Policies	3
Seating Capacity (919) Seats	3
Seating Diagram	3
Parking	3
TRAVEL DIRECTIONS	4
SUPPORT AREAS	5
Dressing Rooms	5
Green Room	5
Front of House	5
Crossover	5
Storage	5
CARPENTRY	6
Load-In Area Dimensions	6
Stage Dimensions	6
HOUSE DRAPERIES (Soft Goods)	7
LINE SET AND RIGGING INFORMATION	8
LINE SET PLOT	9
LINE SET PLOT (<i>continued</i>).....	10
LIGHTING SPECS	11
Lighting Equipment Inventory	11
SOUND	13
SOUND EQUIPMENT INVENTORY	13
WARDROBE	15
Dressing Rooms	15
PROPS	16
Music	16
Dance Floor - Marley	16
Lecterns	16
Pianos	16
STAGE DIAGRAM	17
SEATING DIAGRAM	18
GILLETTE MAP	19

GENERAL INFORMATION

Handicapped Access

- Handicapped seating available upon request: six (6) wheel chair locations house left; five (5) over-sized seating house right;
- Three (3) handicapped restrooms: in lobby, one (1) male, one (1) female, one (1) unisex restroom in west hallway near wheel chair locations.
- Assisted Listening Equipment available upon request

Production Room

Phone and work table.
Wireless internet available in theater lobby.

Green Room

25' x 42' 9" (7.62m x 13.03m); equipped with a small kitchenette including a refrigerator and microwave; can be used as rehearsal space with advance notice

Rehearsal Room

Green room also doubles as a rehearsal space with dance floor, ballet bars on one wall, and mirrors on two walls.

Stage Manager's Console

Located downstage left along the proscenium wall, stationary

Crews

Local non-union crew, mostly students

Policies

- House opens 30 min. prior to curtain
- Building is smoke free unless part of action on stage.
- We video tape 30 seconds of each event for archival purposes.
- Act curtain, orchestra shells, movie screen, electrics and full stage blacks are permanent and will not be stripped.
- Last seven line sets have been cut short on stage left to accommodate unusual stair unit to loading galleries.

Seating Capacity (919) Seats

Seating Diagram

See page 18

Parking

Performance crew parking is available in the parking lot on the northwest side of theatre building.

TRAVEL DIRECTIONS

TRAVEL DIRECTIONS (See Map on Page 19)

- **From I-90:** Take exit 129 and head south on Garner Lake Road approximately 1 mile to CAM-PLEX which is on the left (east) side.
- **From Hwy 59 traveling north (option 1):** At approximately mile post 13 turn right on Garner Lake Road (Jake's Tavern and Honnan Equipment are on the corners). Stay on the road for approximately 2 miles until you reach the 4-way stop. Continue through and CAM-PLEX is located on the right-hand side of the road.
- **From Hwy 59 traveling north (option 2):** From Hwy 59 continue through town until you reach Boxelder Road (Walgreens and Wendy's are on the corners). Turn east (right). Follow the road to the 4-way stop. Turn north (left). CAM-PLEX is located on the right-hand side of the road.
- **From Airport:** Drive south on 2-lane Hwy 14-16 through town for approximately 8 miles. Take a right on Garner Lake Road. CAM-PLEX is located on the left (east) side of the road.

Time Zone

Mountain Standard Time

SUPPORT AREAS

Dressing Rooms

Stage right down one flight of stairs

Green Room

Located in hallway immediately to the right coming from the stage

Front of House

Located stage right through 7' wide hall (2.1m)

Crossover

Located behind the upstage wall and through the shop
or behind upstage black traveler.

Storage

Available in an 800 sq. ft. shop space (18X45)

Notes:

Securing to stage floor is discouraged; however, if required for production any cost of repair to the stage floor after use, will be added to the cost of the production rental, unless prior arrangements have been made.

CARPENTRY

Load-In Area Dimensions

Loading door is 12' - 3" wide x 14' - 2" high (3.7m x 4.3m), one truck can be accommodated at a time, door opens to stage; hydraulic lift available. Easy access to stage and storage. Load in area is at stage level.

See Page 17 for map

Stage Dimensions

Proscenium: 46' wide x 24' high (14.02m x 7.3m), Stage is 40' deep. Apron below plaster line is 11' with a removable orchestra pit cover, stairs from stage right & left can be covered or open.

Wing Space: Stage right is 16' (4.9m) - full stage depth, Stage left is 10' (3.7m) - full stage depth

Grid Height: From deck to top of grid surface is 55' with effective flying height 52'

Orchestra Pit

8'9" (2.7m) wide at center line arcs to 6'1" (1.9m) at ends.

Removable pit covers can adjust the length to 38' 9" (11.8m).

Standard depth is 4'8" (1.4m)

Stage Height: 3'5" (1m) above house floor

Stage Floor: Maple, tongue in groove.

Painted flat black..

(1) 3'3" x 3' (1m x .9m) trap available.

HOUSE DRAPERIES (Soft Goods)

House Curtain: Teal traveler/guillotine combination at up stage of plaster line. Traveler operation line located stage left

Legs: (1) teal velour (8' by 26')
(4) black velour (12' by 26')

Borders: (1) teal velour (12' by 55')
(5) black velour (10' by 55')

Full Stage: (2) black velour, travel line located stage left.
1 is midstage, 1 is upstage
(1) Full blackout upstage-non traveling

Scrim: (1) white and (1) black sharks tooth scrims

Cyclorama: (1) white seamless bleached muslin cyc.

LINE SET AND RIGGING INFORMATION

Working Height of Battens

Electrics

High Trim - 32' above deck (10.7m)

Low Trim - 4'9" above deck (1.4m)

Battens

2" schedule 80 pipe

(46) - 56' (16.2m)

(7) - 50' (15 m)

Type

All lines are single purchase on 8" centers.

Pin Rail

Stage left, ground level.

Arbor Capacity

Maximum load on all but draw curtains 800 lbs. per pipe, 1000 lbs. on Electrics

Available Weight - 10,000 lbs.

Loading Gallery (2) stage left

Mid Rail is 26' above stage floor (7.9m). Mid Rail goes around stage. There are pins and ropes to secure side trees.

Loading Gallery 47' above stage floor (14.3m)

LINE SET PLOT

Line	Distance	Assignment	Special Notes
1	6"	Open	
2	1'2"	Teaser	Teal Color
3	1'10"	Terms	Teal Color
4	2'6"	Main Curtain	Teal Color, Non Move, Guillotine/ Traveler
5	3'2"	open	
6	3'10"	1st Electric	Non Moveable
7	4'6"	open	
8	5'2"	1st Border	Black Color
9	5'10"	1st Legs	Black Color
10	6'6"	open	
11	7'2"	open	
12	7'10"	1st Canopy	Non Moveable
13	8'6"	open	
14	9'2"	2nd Border	Black Color
15	9'10"	open	
16	10'6"	2nd Legs	Black Color
17	11'2"	open	
18	11'10"	2nd Electric	Non Moveable
19	12'6"	open	
20	13'2"	open	
21	13'10"	Movie Screen	Non Moveable
22	14'6"	open	
23	15'2"	Midstage Traveler	Black, Non Moveable, Guillotine/ Traveler
24	15'10"	2nd Canopy	Non Moveable
25	16'6"	Black Scrim	
26	17'2"	3rd Border	Black Color
27	17'10"	open	
28	18'6"	3rd Legs	Black Color
29	19'2"	open	
30	19'10"	3rd Electric	Non Moveable
31	20'6"	open	
32	21'2"	open	
33	21'10"	open	
34	22'6"	open	
35	23'2"	open	
36	23'10"	3rd Canopy	Non Moveable
37	24'6"	open	
38	25'2"	open	
39	25'10"	4th Border	Black Color
40	26'6"	4th Legs	Black Color
41	27'2"	open	
42	27'10"	4th Electric	Non Moveable
43	28'6"	open	

LINE SET PLOT *(continued)*

Line	Distance	Assignment	Special Notes
44	29'2"	5th Border	Black Color
45	29'10"	Upstage Cyc Electric	Cabled, Not an Electric
46	30'6"	open	
47	31'2"	open	
48	31'10"	Upstage Traveler	Non Move, Black, Guillotine/ Traveler
49	32'6"	open	
50	33'2"	open	
51	34'6"	Empty Space – No Lineset	Available.
52	35'2"	White Scrim	
53	35'10"	Bleached White Seamless Cyc	
54	36'6"	Full stage blackout, non-traveling	

Notes

There is a 16 inch space between line sets 50 and 52

Electrics only fly out to 32'

Act Curtain, Orchestra Shells, Movie Screen, Electrics and Full Stage Blacks are permanent and will not be stripped.

Last seven line sets have been cut short on stage left to accommodate unusual stair unit to loading galleries.

LIGHTING SPECS

Power:(1) 400 amp 3 phase, 5 wire, box connector stage right wall.
(1) 400 amp, 3 phase, 5 wire, box connector stage left in shop.
(1) 150 amp 3 phase, 5 wire; panel located stage right.

Dimmers: Strand CD-80. (384) 2.4 kW Dimmers. DMX.

Control Board: ETC Insight lighting console, located in control booth at rear of house with RFU.

Houselights: Control locations both stage left and in lighting control booth
Dimmer or House Light Station Controlled

Circuits: Dimmer Per Circuit 369 - 2.4 kW

Front of House Transfer: Stage right. 32 FOH circuits. Stage Pin

Dimmer Take Control: Booth

Front of House Lighting Positions:

Far Catwalk

Near Catwalk

Proscenium Catwalk

Box Booms: (2) House left and (2) House right – awkwardly angled due to architecture – ask technical staff for details.

Lighting Equipment Inventory

(20) - 10 degree Source Four
(25) - 19 degree Source Four
(26) - 26 degree Source Four
(60) - 36 degree Source Four
(5) - 50 degree Source Four lens barrels
(2) - 36 degree Source Four Jrs., stage pin

(20) - PAR 64 cans, 1 kW, MFL
(40) - 8" Fresnels - 2 kW
(6) - 6" Fresnels - 1 kW
(20) - 6" Source Four Pars – 575 watt.

(6) - Upstage Cyc lights - 3 cells - 1 kW each cell
(15) - 3 circuit strip lights with roundels - 4 lamps a circuit.
150 watt R-lamp

Follow Spots

- (2) - Strong Xenon Super Troupers- (permanently in theater)
- (2) - Lycian Midget HP, Metal Halide 575W- (portable)

Accessories

Various top hats, barndoors, irises, and pattern holders are available.

Side Booms

- (8) - 15' (4.6m) booms
- (8) - 8' (2m) booms
- (8) - 6' booms
- (8) - 2' round bases for booms. (Only 8 booms can be set up at one time)

Cable

Variety of 12 Gauge - SO stage pin jumper, two-fers, several Edison to stage pin adapters available.

Special Effects

- (2) Super Strobe 4 Jule Strobes
- (1) Black Light
- (2) Mirror Balls 18 inches
- (1) DMX LeMaitre Fogger
- (1) DMX LeMaitre Hazer
- (1) DMX LeMaitre Bubble machine
- (1) non DMX fog machine

Gel

We have a large stock selection of Rosco Gel and a fair selection of Lee.
7 days lead time needed for special colors and gobos.

Note: We do have a house plot with a no color front wash, and red, blue, amber and no color overhead washes. The cyc lights are red, blue and green.

SOUND

Power: 150 Amp 3 phase, 5 wire; panel located stage right.

Control Locations: Booth is at rear of house; house mix position located at rear of house under balcony 6' x 8' (1.8m x 2.4m); 75' (22.9m) snake needed to reach stage.

Hearing Assist System: Upon Request

Monitor/Paging: Yes

Clear-Com Communication

- 4 wireless
- 15 belt packs
- 11-single muff headsets
- 2-double muff headsets
- 1-single lightweight

SOUND EQUIPMENT INVENTORY

House Equipment

House Console

Digico SD9

Playback

Denon DND4500 - Dual CD & MP3 Player

House Speakers

Tannoy VQ Series
Lab Gruppen Amplifiers
Lake LM26 DSP

Microphones (Corded and Wireless)

Shure, Sennheiser, AKG, Vega and Crown to suit your needs.

Microphone Stands

Available on request.

No Backline provided by Theater
ask Technical Director for local vendor information

WARDROBE

Dressing Rooms

(2) Star dressing rooms 10' x 12' (3m x 3.7m)

(1) Male chorus dressing room able to accommodate 20 people

(1) Female chorus dressing room able to accommodate 20 people

All dressing room facilities have showers and bathrooms.

A chorus make-up room adjoins the two main dressing rooms.

Dressing rooms are downstairs and are accessible from stage right and stage left.

Irons: 4

Ironing Boards: 4

Steamers: 1

Washers/Dryers: 1 set in shop

Racks and Hanger: 4 rolling racks; permanent racks in each dressing room

Quick Change Booths: Two available as required.

**Gondolas and boxes are limited to stage, shop, or green room.
Nothing large will go downstairs.**

PROPS

Music

Chairs: (68) - Wenger series 500 black
Stands: (76) - Wenger model, black; (18) Wenger 2 shelf, black
Stand Lights: (10) - 120v
Conductor Podium and 2 step riser
Orchestra Shell: (1) -Full Stage Wenger Stage Master Shell, cream color.
Platforms: Various standard sizes available.
Choral Risers: (6) Wenger 3 step risers

Dance Floor - Marley

(4) - 6'7"X 40' (2m) rolls
(1) - 5'3"X40' (1.6m) roll

Lecterns

(2) - full lectern
(2) - table top lectern

Pianos

(1) - 9' (2.7m) Steinway grand concert
(1) - 5'9" (1.75m) Steinway grand
(1) - Yamaha Clavinova CLP-240

STAGE DIAGRAM

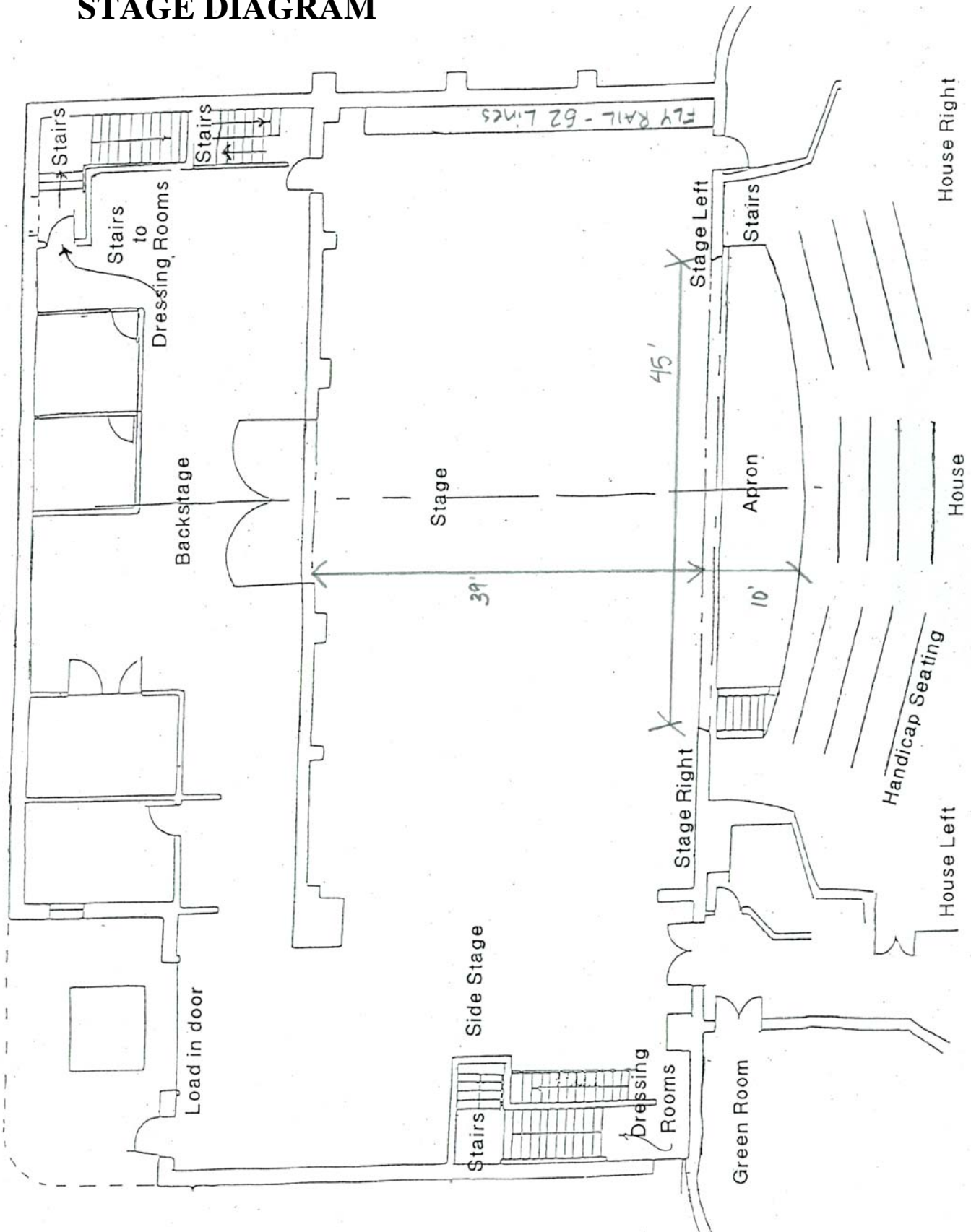

SEATING DIAGRAM

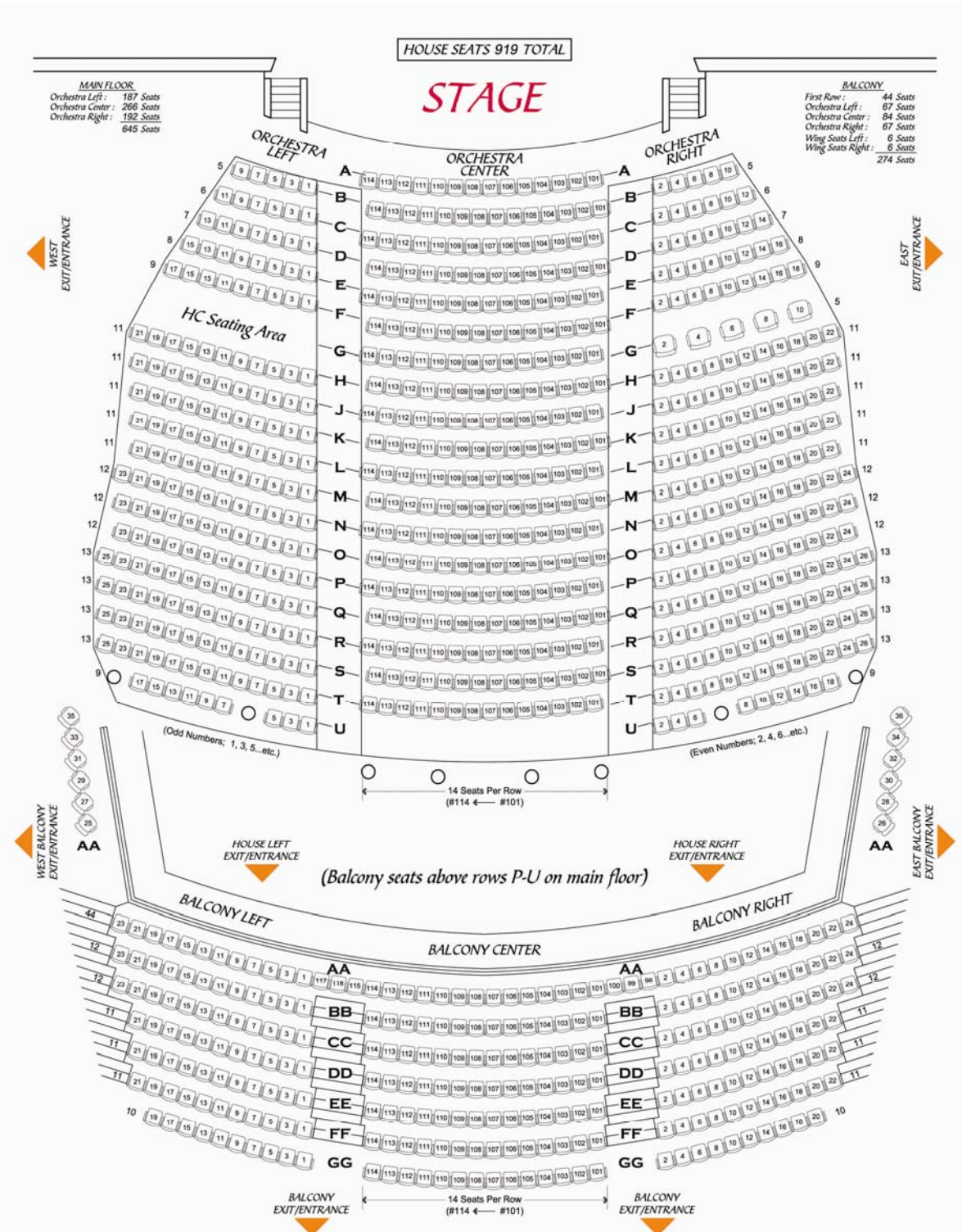

GILLETTE MAP

